

Four Point Bearings QJ 200 Series

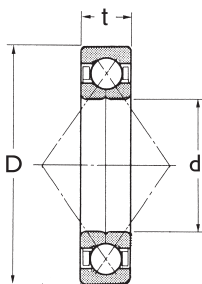

Bearing Number	Dimensions (mm)			Basic Load Ratings (N)		Limiting Speeds (rev/min)		Weight kg
	Bore	OD	Width	<i>C_r</i>	<i>C_{or}</i>	Grease	Oil	
	d	D	t					
QJ208	40	80	18	350	650	6900	9200	0.450
QJ209	45	85	19	400	740	6200	8200	0.520
QJ210	50	90	20	410	800	5600	7500	0.603
QJ211	55	100	21	510	1000	5100	6800	0.780
QJ212	60	110	22	620	1240	4700	6300	0.987
QJ213	65	120	23	680	1380	4400	5800	1.24
QJ214	70	125	24	730	1520	4000	5400	1.36
QJ215	75	130	25	770	1630	3800	5000	1.53
QJ216	80	140	26	900	1940	3500	4700	1.83
QJ217	85	150	28	1000	2240	3300	4400	2.30
QJ218	90	160	30	1180	2630	3100	4200	2.76
QJ219	95	170	32	1350	3120	3000	3900	3.35
QJ220	100	180	34	1450	3220	2800	3700	4.02
QJ221	105	190	36	1570	3620	2700	3600	4.75
QJ222	110	200	38	1700	4030	2500	3400	5.62
QJ224	120	215	40	1930	4840	2300	3100	6.75

QJ 300 Series

Bearing Number	Dimensions (mm)			Basic Load Ratings (N)		Limiting Speeds (rev/min)		Weight kg
	Bore	OD	Width	<i>C_r</i>	<i>C_{or}</i>	Grease	Oil	
	d	D	t					
QJ306	30	72	19	320	540	8000	11000	0.420
QJ307	35	80	21	400	690	7000	9300	0.570
QJ308	40	90	23	500	860	6200	8200	0.078
QJ309	45	100	25	630	1150	5500	7400	1.05
QJ310	50	110	27	740	1380	5000	6700	1.38
QJ311	55	120	29	850	1610	4600	6100	1.76
QJ312	60	130	31	970	1880	4200	5700	2.18
QJ313	65	140	33	1100	2150	3900	5200	2.70
QJ314	70	150	35	1230	2450	3600	4800	3.27
QJ315	75	160	37	1350	2780	3400	4500	3.90
QJ316	80	170	39	1460	3100	3200	4200	4.64
QJ317	85	180	41	1600	3460	3000	4000	5.43
QJ318	90	190	43	1680	3820	2800	3800	6.31
QJ319	95	200	45	1800	4230	2700	3500	7.41
QJ320	100	215	47	2180	5500	2500	3400	9.14
QJ321	105	225	49	2180	5500	2400	3200	10.4
QJ322	110	240	50	1427	6470	2300	3100	12.0
QJ324	120	260	55	2590	7140	2100	2800	15.9